

## **CABINET MEMBER FOR ENVIRONMENT – 7 SEPTEMBER 2017**

### **PROPOSED WAITING RESTRICTIONS, BRASHFIELD ROAD AND GRANVILLE WAY, BICESTER**

#### **Report by Director for Infrastructure Delivery**

#### **Introduction**

1. This report presents objections and other comments received in the course of the statutory consultation on proposals to introduce new waiting restrictions on Brashfield Road and Granville Way, Bicester.

#### **Background**

2. Concerns over the obstruction of traffic and road safety as a result of on-street waiting at a number of locations within the town have been raised by local members and at the Bicester Traffic Advisory Committee, and in response officers identified - in consultation with local members – proposals for waiting restrictions. Following consideration of the responses to a formal consultation held in autumn 2016, amendments were made to some of the proposals after a joint review by officers and members, and a further consultation on all the proposed restrictions as shown in was carried out in March and April 2017 and reported to the Cabinet Member for Environment decisions meeting on 25 May.
3. In considering the responses to the consultation on proposals for Granville Way, revised proposals were identified and taken to a further consultation, as were proposals for Brashfield Road, where an inadvertent omission in the previous consultation had been identified. The proposals are shown in Annexes 1 and 2.

#### **Consultation**

4. The formal consultation on the above carried out between 20 July and 11 August 2017. A public notice was placed in the Bicester Advertiser, and notices placed on site in the immediate vicinity of the proposals. An email was sent to statutory consultees, including Thames Valley Police, the Fire & Rescue Service, Ambulance service, Town & District Councils and the relevant local County Councillors, and letters sent to nearby properties.
5. **Annex 3** provides details of the objections received; copies of the full responses received are available for inspection in the Members Resource Centre.

6. Thames Valley Police expressed no objection to either proposal, and no objections were received from any respondent in respect of the proposals for Granville Way.
7. Fourteen responses were received from members of the public in respect of the proposal for Brashfield Road, comprising nine objections and five expressions of support. The objections were primarily on the grounds that the proposal would transfer the commuter parking problem to other parts of Brashfield Road and adjacent roads, and requested a more comprehensive approach to addressing the parking problems in this part of Bicester; some respondents expressed the view that a residents parking scheme was needed. Several of the responses expressing support for the proposal nevertheless cited similar concerns that a more comprehensive approach is needed to satisfactorily address commuter parking in residential roads.

### **Response to objections and concerns**

8. Very careful consideration has been given to balancing the competing interests of residents so affected and others who are adversely affected by the current levels of parking by non-residents, including commuters. In view of the above it is considered – also taking account of the very considerable input by local members into this review – that the proposals are appropriate and proportionate. Should the proposals be approved, monitoring will be carried out to assess their impact – including whether parking problems have been moved to other locations - and the need for any modifications or additional measures.
9. In respect of the requests for a residents parking scheme, the county council's long-standing position with regard to further residents parking schemes is that these will not be considered prior to the introduction of Civil Parking Enforcement (i.e. enforcement by local authority rather than Police); there is currently no agreement between county council and Cherwell District Council on the timetable for this to happen in Cherwell

### **How the Project supports LTP4 Objectives**

10. The proposals would help facilitate the safe movement of traffic and pedestrians.

### **Financial and Staff Implications (including Revenue)**

11. The appraisal of the proposals, consultation and preparation of all paperwork has been undertaken by Communities officers as part of their normal duties.

## **RECOMMENDATION**

- 12. The Cabinet Member for the Environment is RECOMMENDED to approve the implementation of the proposals as advertised and described in the report.**

OWEN JENKINS

Director for Infrastructure Delivery

Background papers:            Consultation responses

Contact Officers:                Anthony Kirkwood 07392 318871

September 2017

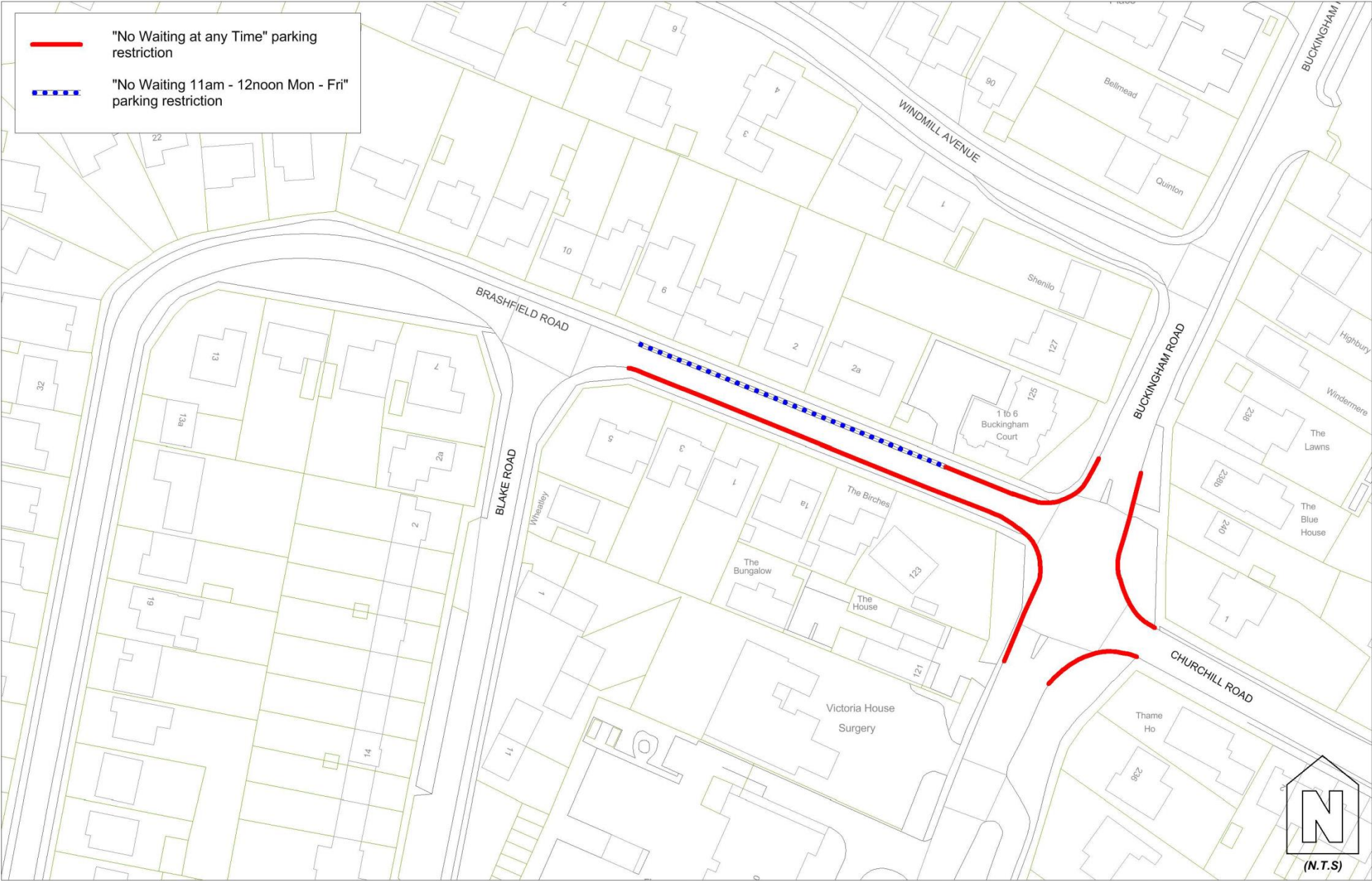

Reproduced from the Ordnance Survey mapping with permission of the Controller of Her Majesty's Stationery Office © Crown Copyright  
 Unauthorised reproduction infringes Crown Copyright and may lead to prosecution or civil proceedings.  
 Oxfordshire County Council. © Crown Copyright and database rights 2017. 100023343



Date drawn: 09/03/2017  
 Drawn by: CJM

Map centre:  
 easting, 458513, northing, 223658

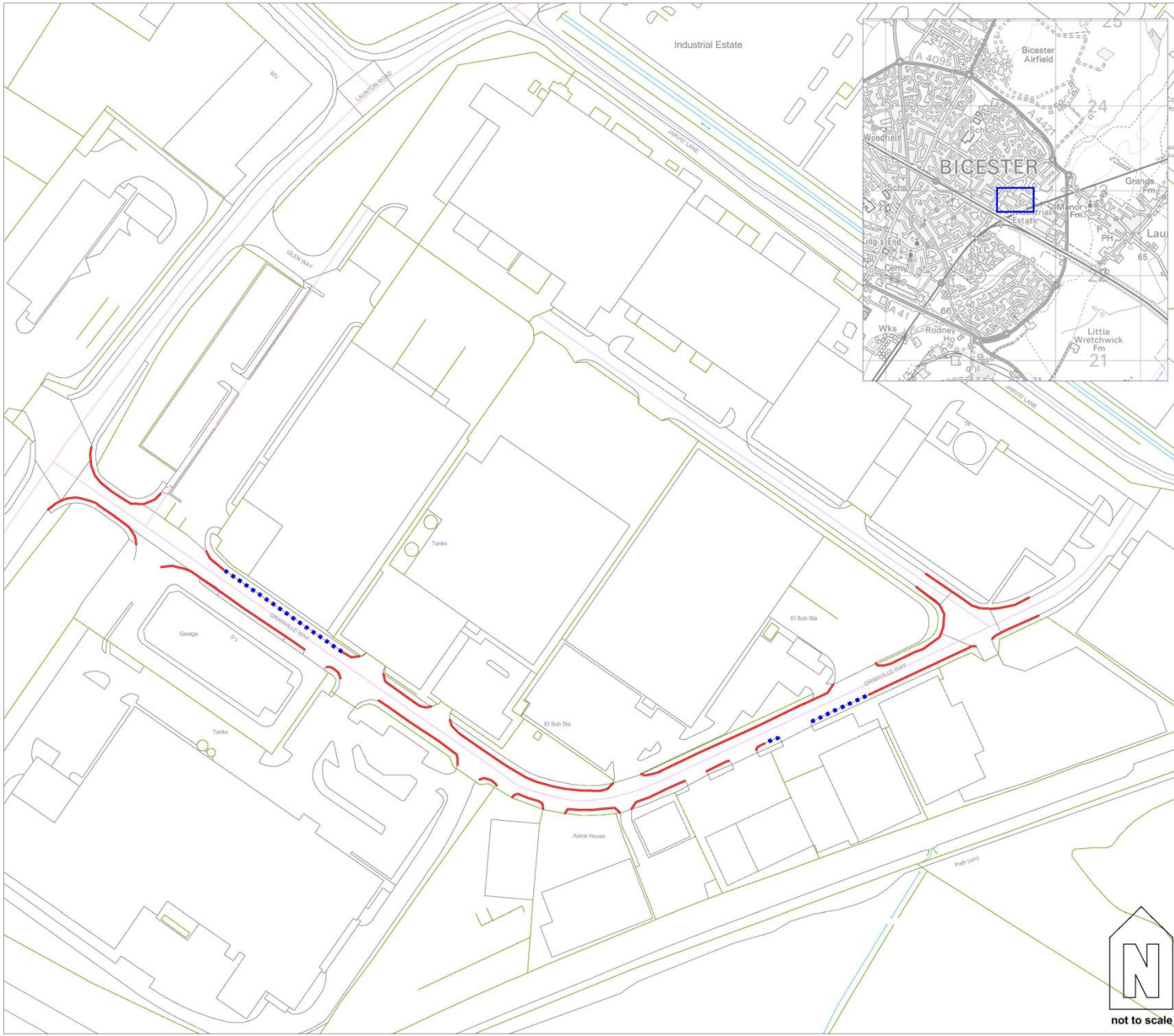

- — Proposed "No Waiting at Any Time" waiting restriction (double-yellow lines)
- - - - Proposed Parking for Cars and Light Vans only (excluding HGV's)

Site Location

Reproduced from the Ordnance Survey mapping with permission of the Controller of Her Majesty's Stationery Office © Crown Copyright. Unauthorised reproduction infringes Crown Copyright and may lead to prosecution or civil proceedings. Oxfordshire County Council. © Crown Copyright and database rights 2016. 100023343

 **OXFORDSHIRE COUNTY COUNCIL**  
 Chris McCarthy (Interim Director)  
 Infrastructure Delivery  
 Communities  
 Oxfordshire County Council  
 County Hall  
 New Road  
 Oxford  
 OX1 1ND  
 Tel: (0345 310 1111)

**TRAFFIC REGULATION ORDER  
 RE-CONSULTATION DRAWING**

**GRANVILLE WAY, BICESTER  
 PROPOSED PARKING RESTRICTIONS**

Drawing Status		
Drawn by:	Checked by:	Approved by:
CJM	ADK	
Date drawn:	Date checked:	Date approved:
05/06/2017	05/06/2017	



RESPONDENT	SUMMARISED COMMENTS
(1) Thames Valley Police	<b>No objection.</b>
(2) Local Resident, (Linden Road, Bicester)	<p><u>Brashfield Road</u> – <b>Support</b> - As previously commented in the more recent proposals for additional regulations in the town centre, the current single and double yellow line no waiting /parking regulations are largely ignored at several locations around the town centre owing to the lack of enforcement. Whilst this proposal will have a deterrent effect, the whole of Bicester's parking restrictions need to be deregulated to allow civilian enforcement by the local authority.</p> <p><u>Granville Way</u> – <b>Support</b> – As previously commented in the more recent proposals for additional regulations in the town centre, the current single and double yellow line no waiting /parking regulations are largely ignored at several locations around the town centre owing to the lack of enforcement. Whilst this proposal will have a deterrent effect, the whole of Bicester's parking restrictions need to be deregulated to allow civilian enforcement by the local authority.</p>
(3) Local Resident, (Brashfield Road, Bicester)	<p><u>Brashfield Road</u> – <b>Object</b> - When the original consultation was carried out almost all residents signed a petition stating that while they agreed with the proposals they did not go far enough; the proposed restrictions will just relocate the parking problem is only being moved further down the road. Requests No Waiting 11am - 12noon one side of the road and No Waiting 12noon - 1pm on the other side Mon-Fri to address commuter parking. The other approved proposals in the area will similarly lead to commuter parking being relocated; All the nearest areas to Bicester North Station must be covered, rather than a piecemeal approach.</p> <p><u>Granville Way</u> – <b>Neither</b> – <i>No comment.</i></p>
(4) Local Resident, (Brashfield Road, Bicester)	<p><u>Brashfield Road</u> – <b>Object</b> - The proposed parking restrictions will only push the current parking offenders to park further down Brashfield Road. – a No Waiting 11am - 12noon Mon - Fri parking restriction should apply to all of Brashfield Road as we all have driveways.</p> <p><u>Granville Way</u> – <b>Neither</b> – <i>No comment.</i></p>
(5) Local Resident, (Brashfield Road, Bicester)	<p><u>Brashfield Road</u> – <b>Object</b> – These waiting restrictions only will serve to push the parking problem further down the road. Either the entire road should be 'no parking' or leave the road as it is. Our parking problem is caused by insufficient parking in Buckingham Road for businesses and the surgery. Current parking stops me from getting out of my drive and forces me to have to dive over the council grass and kerb. Also requests traffic calming measures due to recent accidents.</p> <p><u>Granville Way</u> – <b>Neither</b> – <i>No comment.</i></p>

CMDE7

<p>(6) Local Resident, (Brashfield Road, Bicester)</p>	<p><u>Brashfield Road</u> – <b>Object</b> – I object because the people parking will just move further round the road and still cause problems on what is already a very busy thoroughfare and cut through between Buckingham &amp; Banbury roads. <u>Granville Way</u> – <b>Neither</b> – <i>No comment.</i></p>
<p>(7) Local Resident, (Woodfield Road, Bicester)</p>	<p><u>Brashfield Road</u> – <b>Support</b> – but further measures are required including at the Banbury Road end of Brashfield Road, which is always congested an emergency vehicles would struggle to get through most of the time. Woodfield Road also suffers from commuter parking including from the station. On many occasion ambulances attending to frail residents nearby park on my drive as there is nowhere else for them to park. <u>Granville Way</u> – <b>Neither</b> – <i>No comment.</i></p>
<p>(8) Local Resident, (Windmill Avenue, Bicester)</p>	<p><u>Brashfield Road</u> – <b>Support</b> – but concerned these will relocate the problem; noting an increase in cars parking on Windmill Avenue - perhaps the same restrictions should also apply here. <u>Granville Way</u> – <b>Support</b> - but also note that the problems may be relocated.</p>
<p>(9) Local Resident, (Windmill Avenue, Bicester)</p>	<p><u>Brashfield Road</u> – <b>Support</b> – but also concerned that they will only move the problem to Windmill Avenue. Parking restrictions are needed here as well, especially at junction of Windmill Avenue/Buckingham road as several cars are parking there each day, close to the junction presenting a serious safety risk. <u>Granville Way</u> – <b>Support</b> – <i>No comment.</i></p>
<p>(10) Local Resident, (Brashfield Road, Bicester)</p>	<p><u>Brashfield Road</u> – <b>Object</b> – This does not address the underlying reasons as to why this is a problem in the first place. All this will do is move the parked cars further down Brashfield Road, causing visibility problems close to what is already a dangerous bend. You need to consider double yellow lines opposite every driveway to enable the occupants to be able to safely enter and leave their own premises. The cars at the entrance to Brashfield Road are illegally parked too close to the junction - the traffic police should be dealing with this. <u>Granville Way</u> – <b>Neither</b> – <i>No comment.</i></p>
<p>(11) Local Resident, (Brashfield Road, Bicester)</p>	<p><u>Brashfield Road</u> – <b>Object</b> – This proposal does not address the cause of the multiple vehicles parked in Brashfield Road, including the surgery. The proposal will result in the vehicles parking elsewhere causing serious visibility problems near the bend and for residents living after the proposed yellow line/restricted parking part of the road. The restriction should be applied on the whole length of the road to the waiting time be applied to the whole road. <u>Granville Way</u> – <b>Neither</b> – <i>No comment.</i></p>
<p>(12) Local Resident, (Brashfield Road, Bicester)</p>	<p><u>Brahfielld Road</u> – <b>Object</b> – All this will do is move the problem further down the road <u>Granville Way</u> – <b>Neither</b> – <i>No comment.</i></p>
<p>(13) Local Resident, (Brashfield Road, Bicester)</p>	<p><u>Brashfield Road</u> – <b>Object</b> - requests resident parking permit scheme to address the problems, including due to the Toad Hall nursery, surgery and rail station. Also concerned about the use of the road as a cut through between Banbury Road and Buckingham Road and vehicles speed through here.</p>

CMDE7

<p>(14) Local Resident, (Brashfield Road, Bicester)</p>	<p><u>Brashfield Road</u> – <b>Object</b> – What you are proposing will only relocate the parking problems; a residents parking scheme is required (to be funded by Chiltern Railways, Toad Hall Nursery, Victoria Health Centre, Oxfordshire County Council and Cherwell District Council for granting Planning Permission for both Toad Hall Nursery and Victoria Health Centre without any consideration to the parking problems.</p>
<p>(15) Local Resident, (Brashfield Road, Bicester)</p>	<p><u>Brashfield Road</u> – <b>Support</b> –the only concern is that the parking does not move further down the road, and also that the proposed Monday to Friday between 11am-12noon restriction is enforced.</p>